

Kaelin Andrus • Field Skills
Table of Contents

April 17, 2023 pg. 1
Longhouse Gardens

April 23, 2023 pg. 4
Percivle Creek Watershed

24 April 2023 pg. 7
In-class Field
measurement

01 May 2023 pg. 13
Evergreen Beach
organism I.D.

07 May 2023 pg. 13
Rock Candy Mountain
E. loop Trail
Biodiversity

08 May 2023
Evergreen Beach
Quadrat survey

14 May 2023

pg. 17

Biodiversity Skills Part 2
Homework

April 17, 2023

Andrus 1

11 AM 47°F (8.333°C)

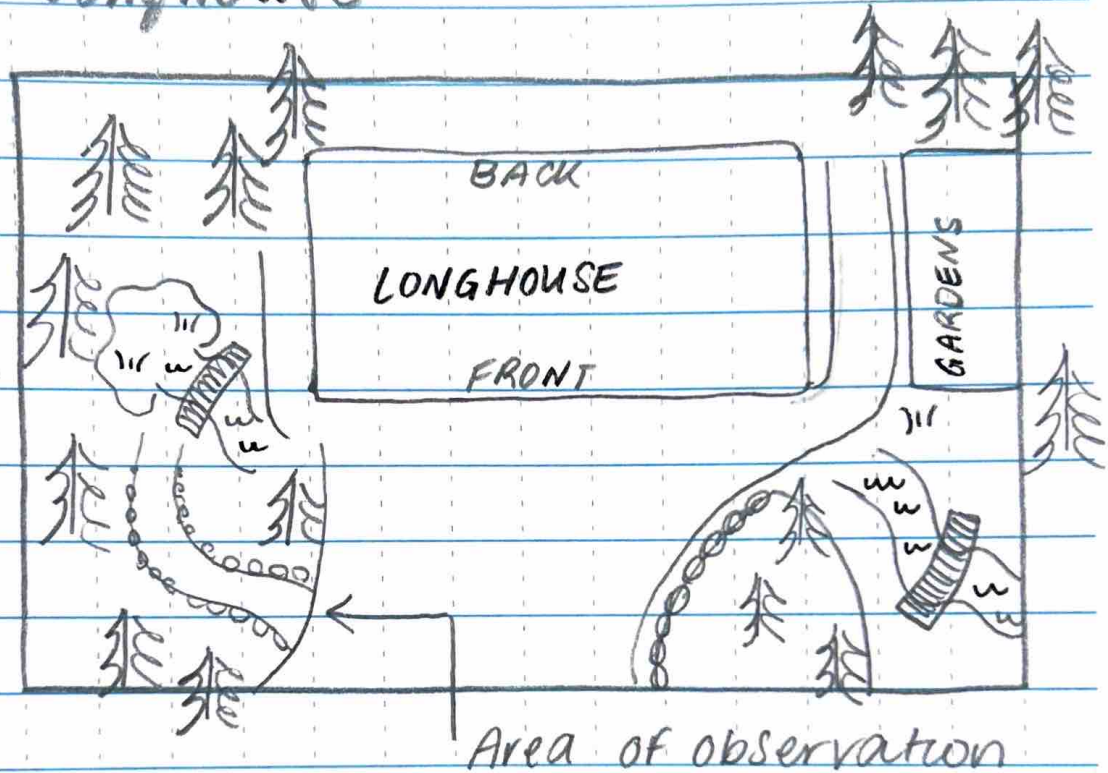
The Evergreen State College
Longhouse

Location: 47.0725°
 -122.9738°

Near the entrance of a short trail located near the front left of the Longhouse (if facing the front of the building.)

Wind: Beaufort 1 (2-5 km/h)

Sky condition: overcast + cloudy (2)
 Wooded area, open canopy.

Forest is dominated by Douglas Fir and Cedar.

Scale: 1 square = _____

Andruss 2

We began by choosing an area to observe for one hour. At first we focused on a 1m plot, then shifted focus to the wider surrounding area.

Within my 1 m, precise plot:

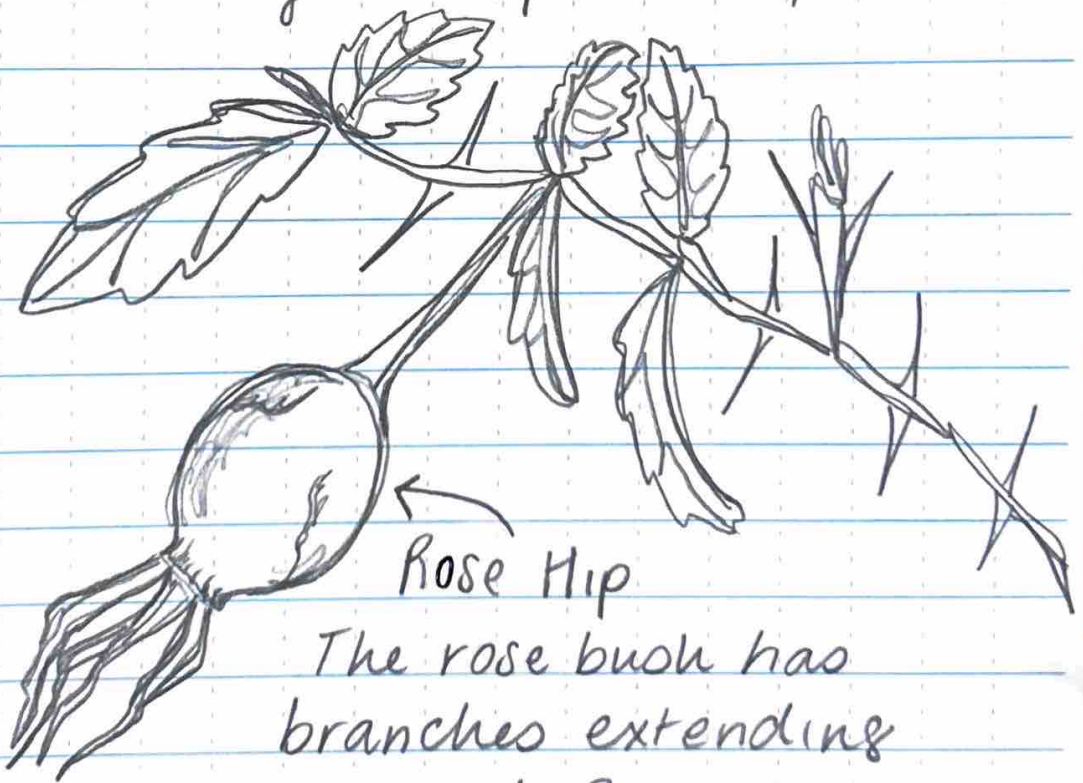

The rose bush has branches extending around 2m out of the ground, with green, toothed leaves. The rosehips are bright orange/red.



Andruss 3

Soil in area is dark, and compacted on the path. Soil off-path is covered with wood chips, sticks, and layers of wet leaves.

At 11:47 AM it begins to rain.
(A light sprinkle)

Western Sword Ferns
in abundance
(*Polystichum munitum*)

Possible sightings:

- Salal, Rhubarb, *Ranunculus hexandra*

A stream leads to a marshy area, where yellow skunk cabbage protrudes from the water.

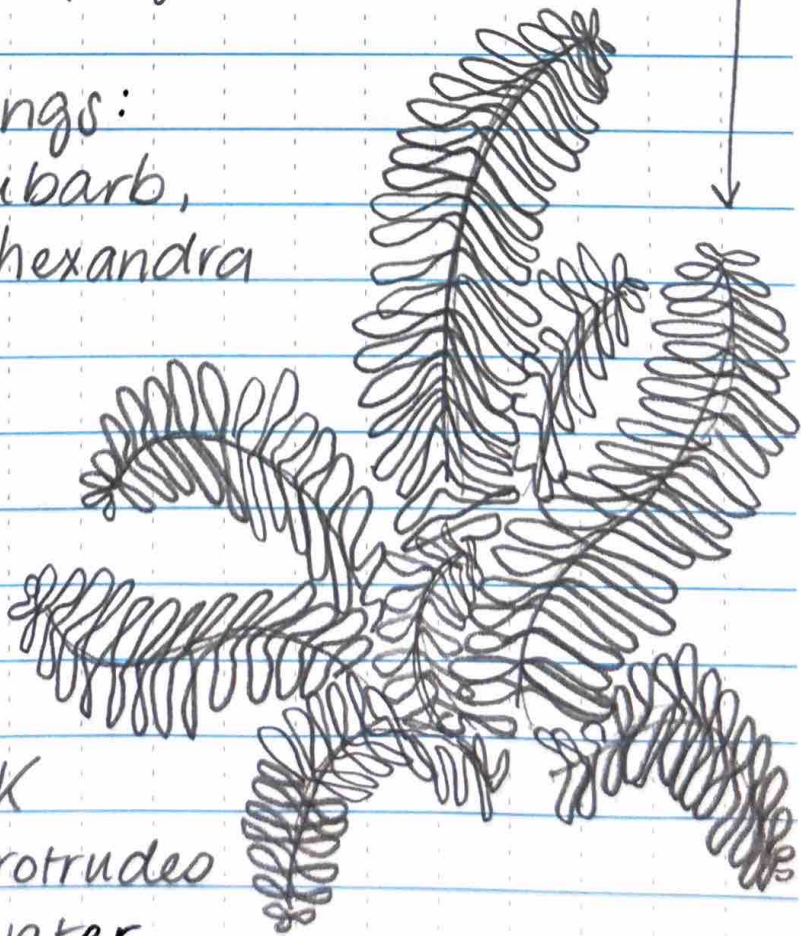

April 23, 2023

Andruss 4

15:00 49°F (9.444°C)

wind 1-3 mph / 2-5 km/hr

(Beaufort 1)

sky conditions: overcast + cloudy (2)

Percival Creek Watershed

Percival Creek via Sapp Road

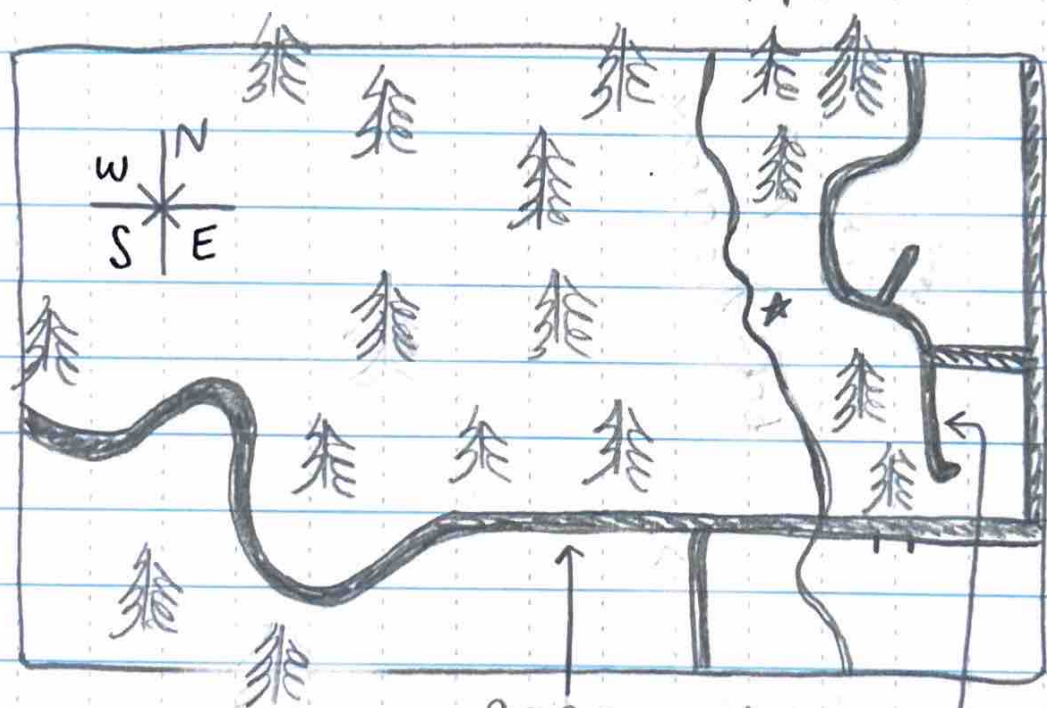

[* = Area of Observation]

Cassie Dr. SW

Antsen St. SW

Location: 47.01253° N

122.93311° W

Entered trail head off Sapp Rd.
+ walked through forest / closed
canopy until reaching a clearing
with creek access (*)

Scale: 1 square =

(2) In my 1m area of observation,
I spotted 2 red-legged frogs
(10cm, 5.5cm), the tiniest
Pacific Tree Frog (<2.5cm), an
ant colony, and a sparrow
(possibly Lincoln's sparrow) looking
for a snack.

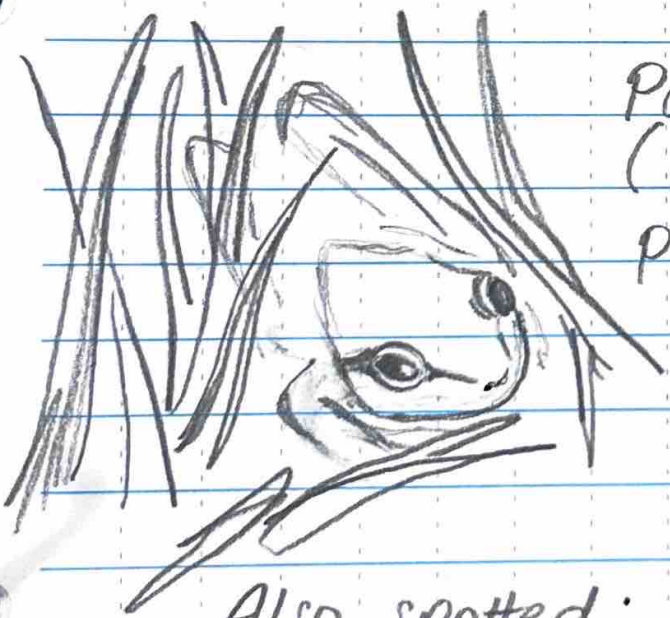

Pacific Tree Frog
(*Hyla regilla*)
peeking out of the
water + grass

Also spotted:
Pacific Banana Slug
+ Black Slug

Some kind of
Swamp cabbage?
<Horse Tail >

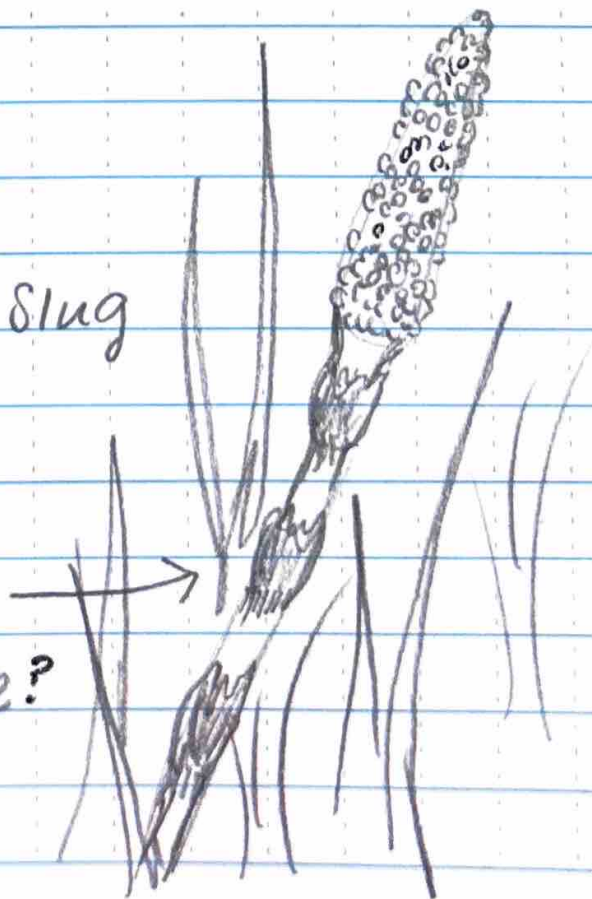

Scale: 1 square = _____

Andruss 6

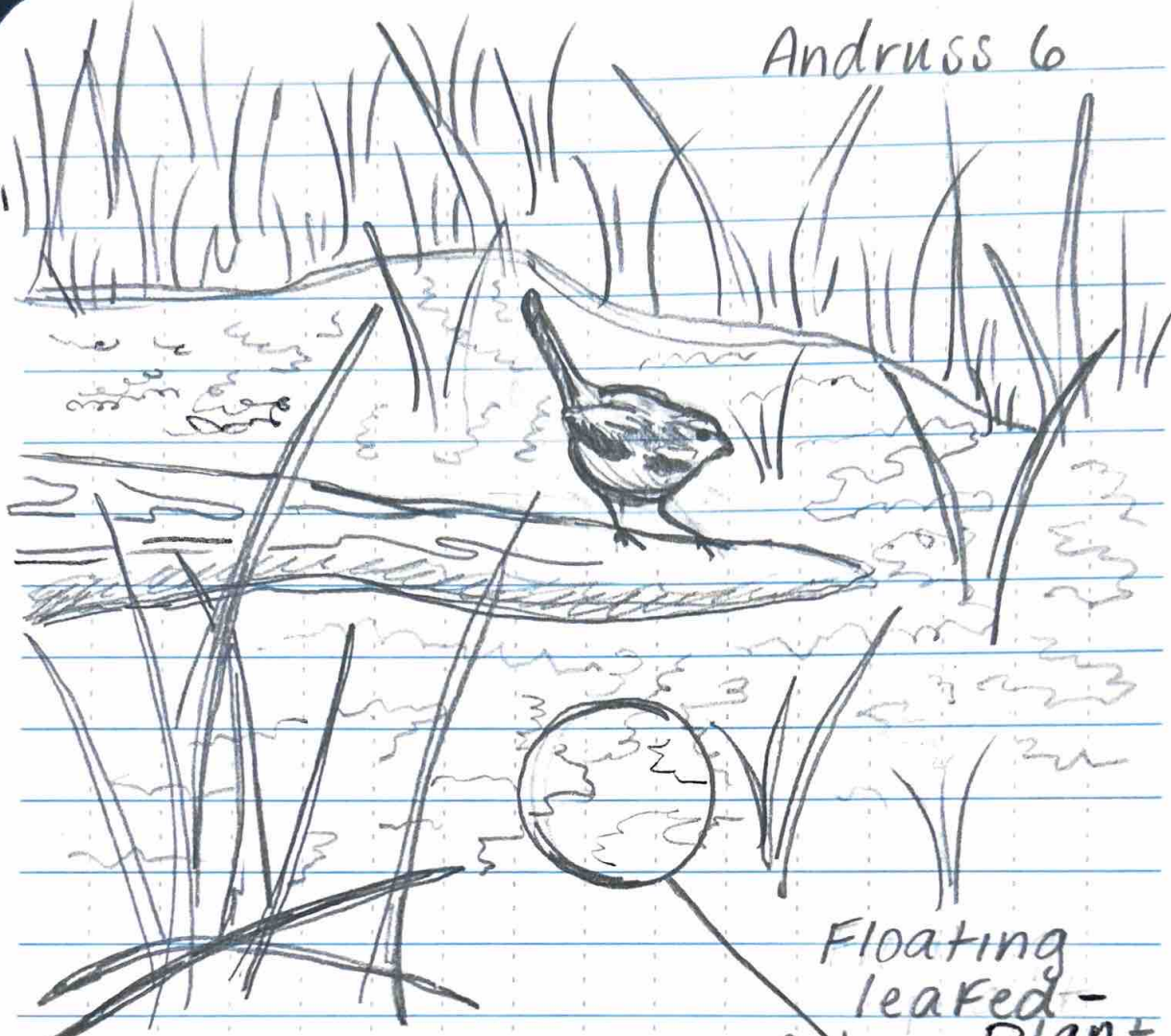

Lincoln's sparrow
or Savannah
sparrow looking
for a snack in
the water.

Floating
leafed-
plant

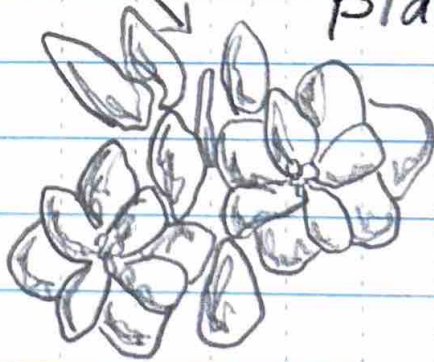

The creek is surrounded by
Cattail (*Typha latifolia*)

24 April, 2023

10.3°C (50.4°F)

Wind: 0 < 2 Km/hr

Sky: 1 partly cloudy

Location: on the walkway west
of the lab buildings.

47.0718°N, 122.97896°W

Built environment

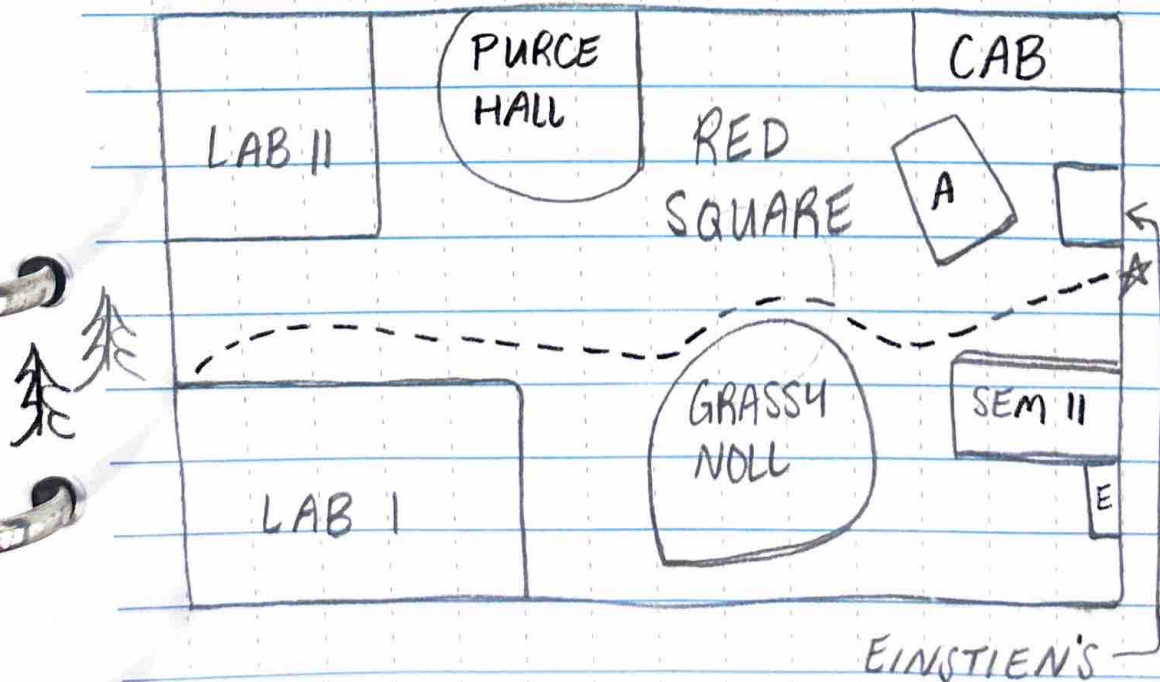
surrounded by 2nd growth
temperate rain forest

Temperate Forest, covered
canopy. Beaufort 1
Sky conditions: cloudy (2)

Measurement 1:

Bumble Bee

Bombus bifarius



Measurement: 2cm
(estimated based on
finger-segment length)

Measurement 2:

Pink Flowers (the
bees were interested in)

Possibly Salmonberry

Rubus spectabilis



Measurement: 2.5cm, slightly
larger than the bees.

Measurement 3:

Distance away from bees
and salmonberry: 8m

Estimating Coverage + Density (Working with Addie)

In our 10m length, with a ground cover height of 20cm, we found 75% coverage.

Ground cover included:

Sword Fern, Salal, Oregon grape, doug-fir branches, blackberry, huckleberry, yellow violet, liverwort, and leaf-litter.

Study Idea using Environmental Field Measurements +

Estimations: Fish + Amphibian Inventory. When surveying specific species of fish, it is helpful to approximate size, as many non-native and native species appear similar in color, while differing in size.

07 May 2023 10:00 AM

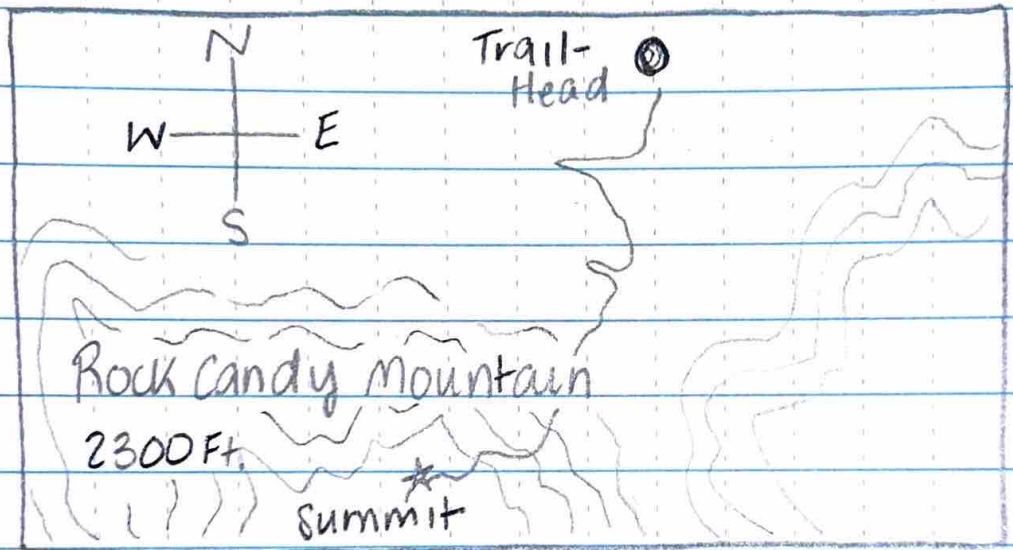
Rock Candy Mountain E. Trail
Capital State Forest

Trail head : $47.03594^{\circ}N$
 $123.09117^{\circ}W$

Beaufort 1

Sky conditions 2

Trail is through a working forest, and passes through areas that have been clear-cut.

Majority of the trail is under a closed canopy.

Elevation gain is 1,837 ft.

Forest is mostly Douglas Fir.

Organism I.D.

(in order of appearance)

Ground Cover Plants

- Arctic sweet coltsfoot

order: Asterales

Family: Asteraceae

Genus: Petasites

Species: P. frigidus

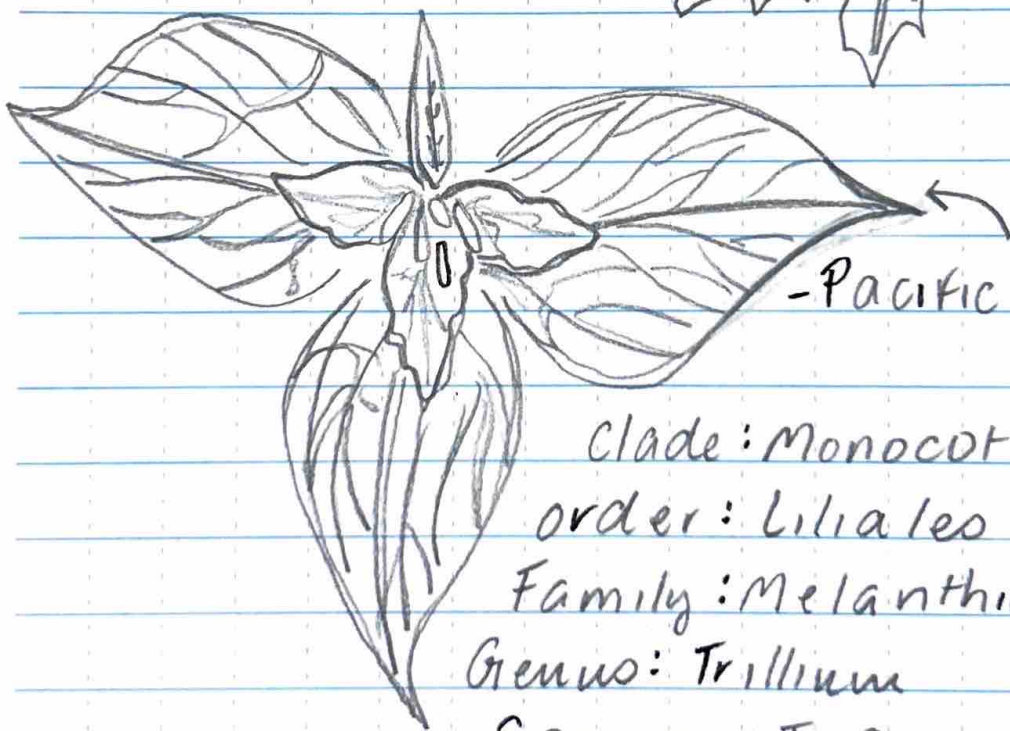
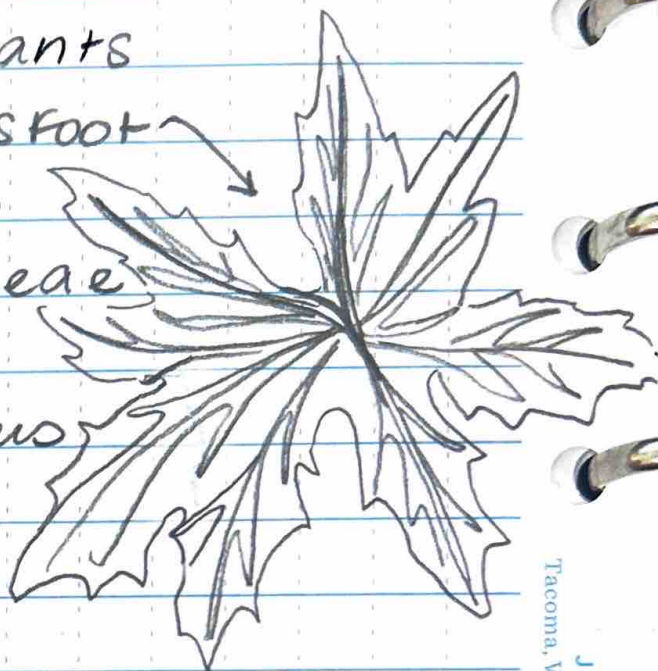

- Pacific Trillium

Clade: Monocots

order: Liliales

Family: Melanthiaceae

Genus: Trillium

Species: T. ovatum

- Salal (a species of Snowberries)

Gaultheria shallon

(Most common ground cover in this area)

Tacoma, WA, USA • RiteintheRain.com

JL DARLING LLC

- California Blackberry

order: Rosales

Family: Rosaceae

Genus: Rubus

Species: *R. ursinus*

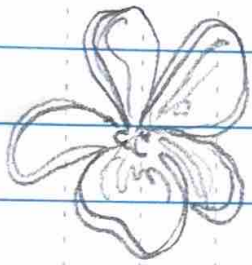
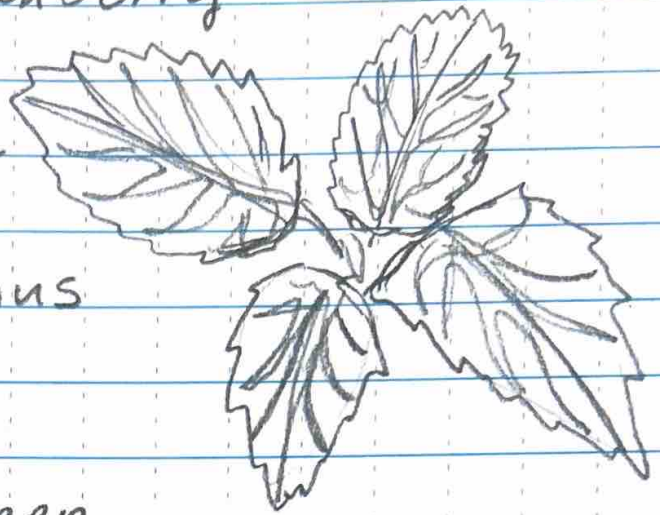

- Evergreen

Violet

Clade: Rosids

order: Malpighiales

Family: Violaceae

Genus: *Viola*

Species: *V. sempervirens*

- Thimbleberry (Species of
brambles)

Clade: Rosids

order: Rosales

Family: Rosaceae

Genus: *Rubus*

Species: *R. parviflorus*

(has toothed leaves, similar to
blackberry.)

- Common Holly
- clade: Asterids
- order: Aquifoliales
- Family: Aquifoliaceae
- Genus: *Ilex*
- Species: *I. aquifolium*

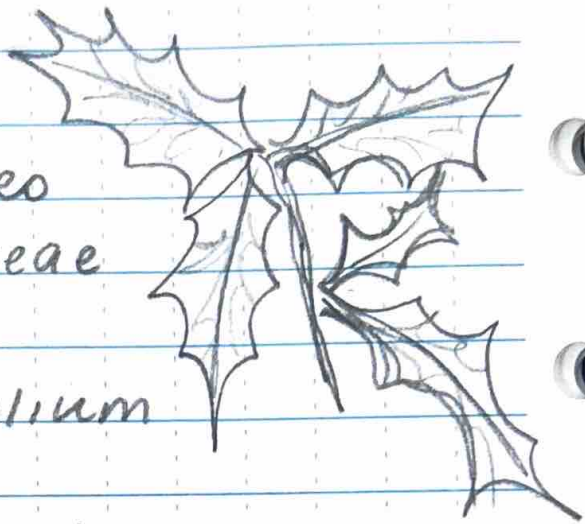

- Pacific Bleeding Heart

clade: Eudicots
 order: Ranunculales
 Family: Papaveraceae
 Genus: *Dicentra*
 Species: *D. formosa*

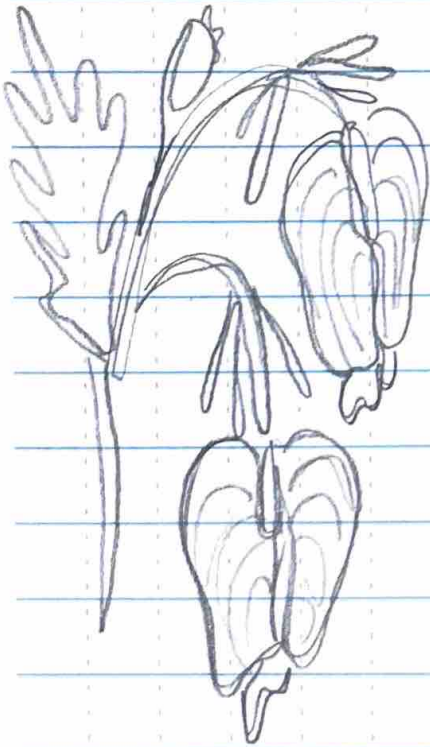

At 12:00 pm, the wind picked up and I concluded my observations.

14 May 2023

Andrus 17

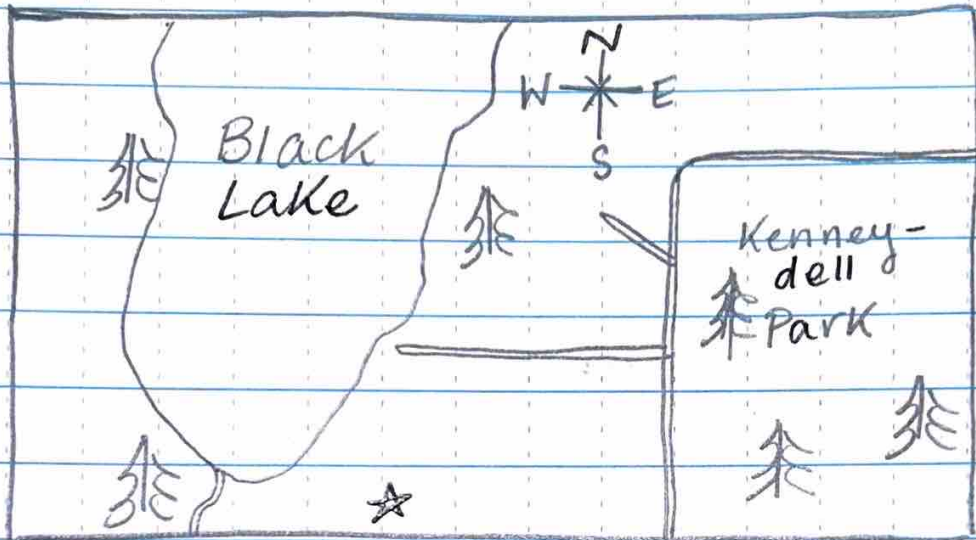
Black Lake - surrounding
Forest.

★
↑ Area of Observation

Location: $46.97395^{\circ}N$
 $122.97939^{\circ}W$

Beaufort 2

Sky conditions

11:30 AM 84°F

Biodiversity Skills Part 2

Transect Plant Survey

(ground cover sample
50 cm above ground)

Survey taken near a pond.

Scale: 1 square = _____

Andruss 18

Transect over 10 meters at
50 cm above ground

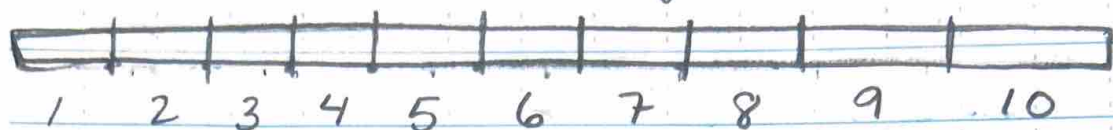

- 1) Snakeberry, doug-fir branches
- 2) Snakeberry, salal,
oregon grape
- 3) salal, Western Sword Fern
- 4) salal, evergreen violet
- 5) Snakeberry, California
Blackberry
- 6) Western Sword Fern,
California Blackberry
- 7) doug-fir branches, salal,
thimbleberry
- 8) Snakeberry, salal, Western
Sword Fern
- 9) Western Sword Fern, salal,
doug-fir branches
- 10) oregon grape, salal,
California Blackberry

Andrusso 19

Snakeberry	3
doug-fir branches	3
salal	7
oregon grape	2
Western Sword Fern	4
Evergreen Violet	1
California Blackberry	3
Thumble berry	1

Species Accumulation

Cumulative

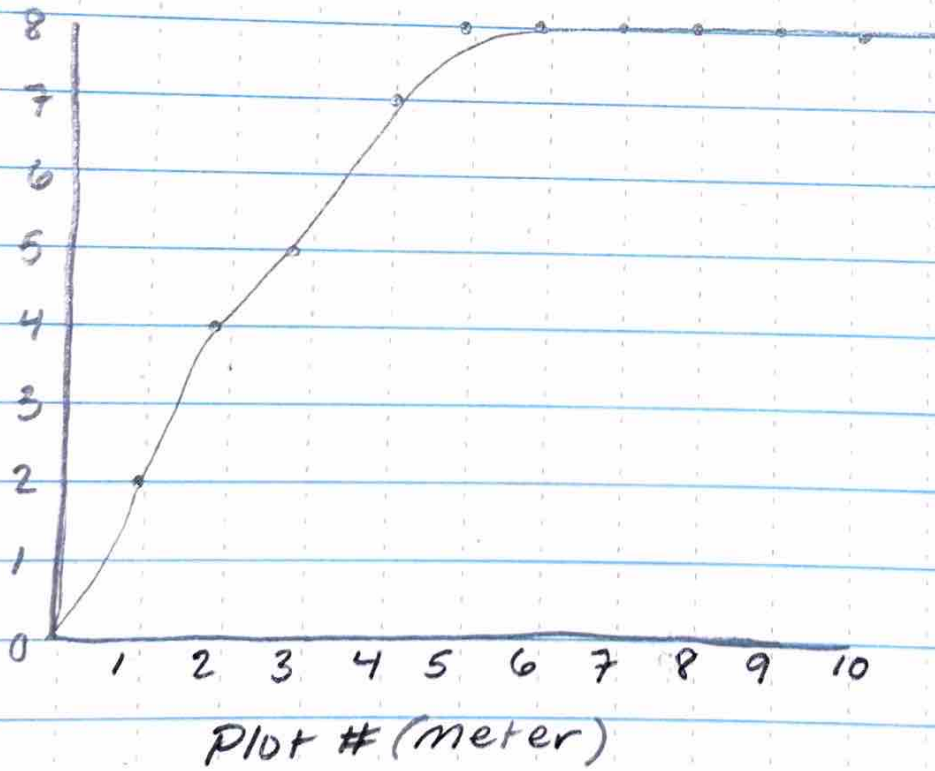

Plot in the Rain

Richness Abundance Plot

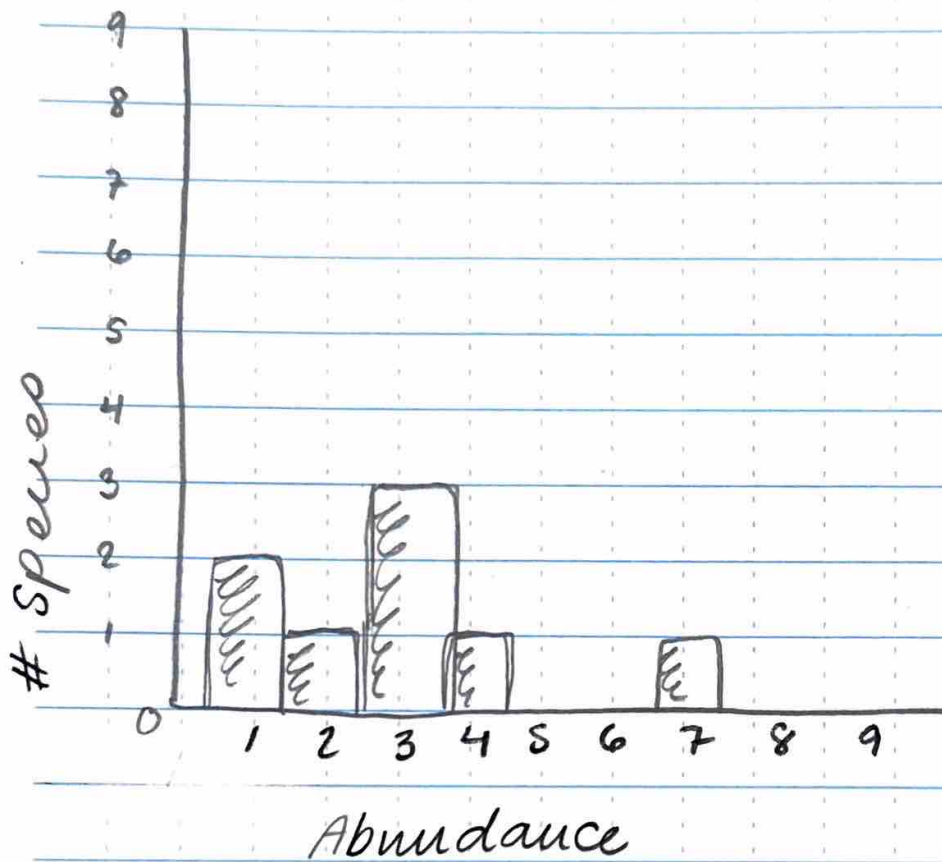

By 12:00 pm, the wind picked up and moved more doug-fir branches onto the transect, which would have made them the dominating species of the 10 meters (if we were to count them as plants in this survey)